

# FUNCTIONS and FEATURES

## CDL6i Leakage Protection Switch

### CDL6i - Leakage Protection Switch

Leakage protection switch has the following functions

- Leakage protection function
- Isolation function

#### Main Features

Rated working voltage (V)	230/400 AC
Rated current (A)	10, 16, 20, 25, 32, 40, 63, 80, 100
Rated frequency (Hz)	50/60
Number of poles	2P, 4P
Rated residual making and breaking capacity $I_m$ (A)	$I_n < 63A, 500A; I_n \geq 63A, 10I_n$
Rated limited short-circuit current $I_{\Delta c}$ (A)	6000
Rated residual operating current $I_{\Delta n}$ (mA)	30, 100, 300
Leakage action time (s)	$t < 0.1$

Comply with standard

IEC61008-1 GB/T 16916.1

Comply with certification



#### Product detail presentation

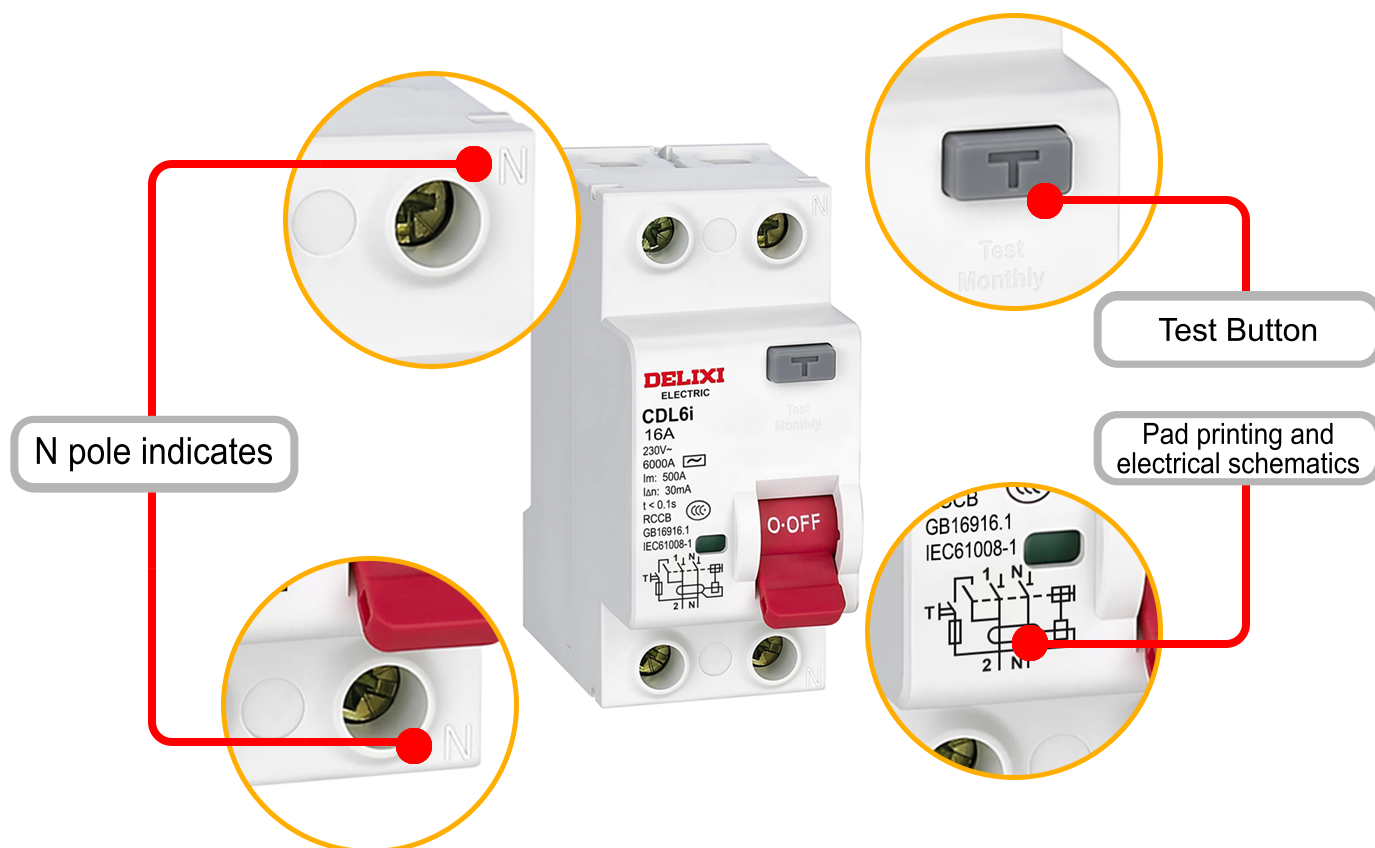

## FUNCTIONS and FEATURES

### CDL6i Leakage Protection Switch

#### Product code detail

Product name	Number of Poles	Rated current	Residual current	Product type
CDL6i	2	10	S	C
	2: 2P 4: 4P	10: 10A 16: 16A 20: 20A 25: 25A 32: 32A 40: 40A 63: 63A 80: 80A 100: 100A	S: 30mA Y: 100mA T: 300mA	C: AC

#### Product front description

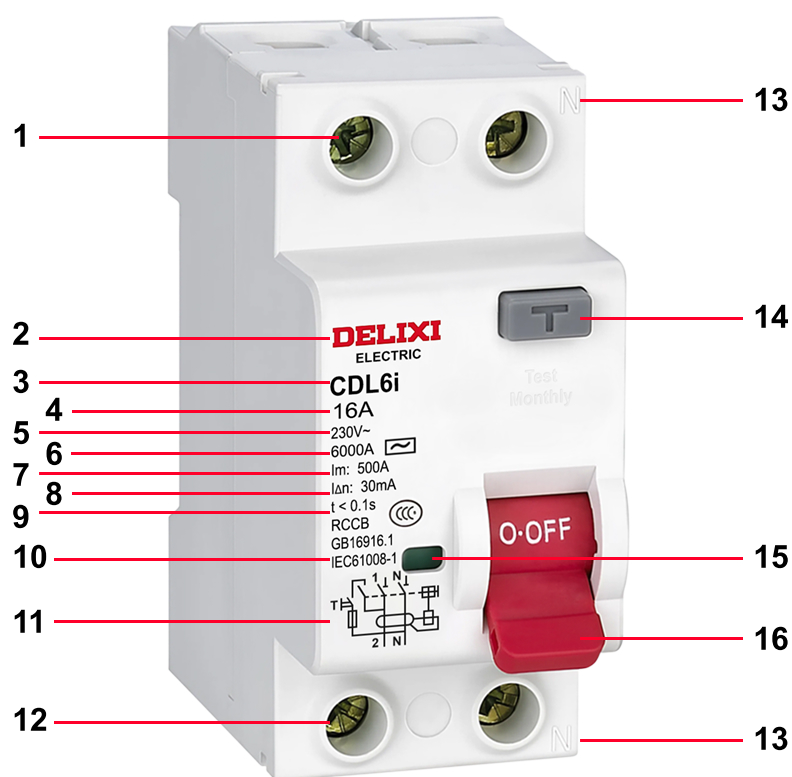

1. Power supply terminal
2. Company trademark
3. Product model
4. Rated current: 63,80,100,125
5. Rated voltage: 230V (1P) /400V
6. Rated limited short-circuit current  $I_{\Delta c}$  (A)
7. Rated residual making and breaking capacity  $I_m$  (A)
8. Rated residual operating current  $I_{\Delta n}$  (mA)

9. Leakage action time (s)
10. Comply with standard
11. Wiring diagram
12. Load side
13. "N" pole indicates
14. Reset button
15. Contact indication
16. Handle Switch

# FUNCTIONS and FEATURES

## CDL6i Leakage Protection Switch

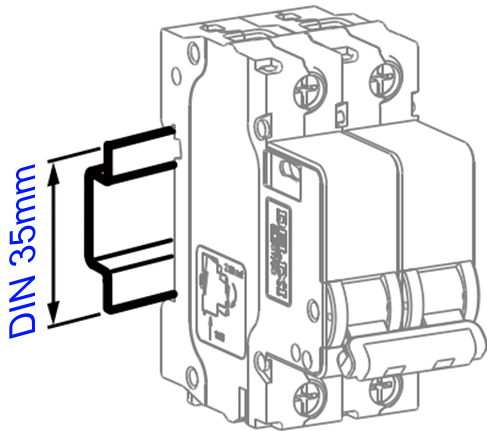

Installed on 35mm standard rail

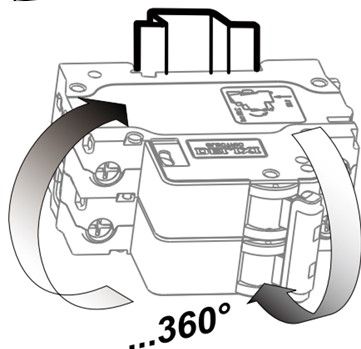
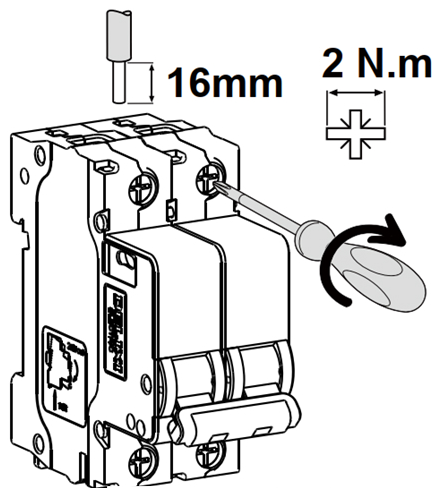
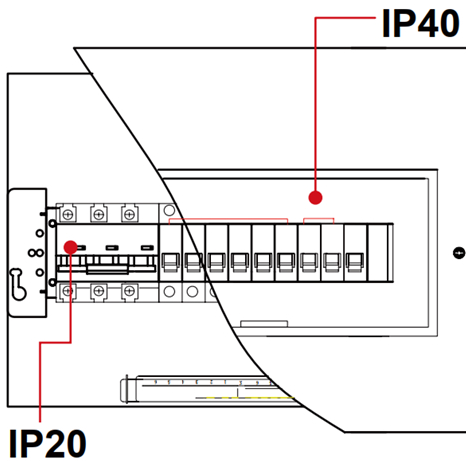

Flexible installation direction

### Electrical characteristics

Rated insulation voltage $U_i$ (V)	500
Rated impulse withstand voltage $U_{imp}$ (kV)	4
Trip form	electromagnetic
Product Type	AC, A
Dielectric test voltage (kV)	2kV (50Hz, 1 minute)
Isolation	function available
Pollution level	2
Protection against electric shock class	II
Altitude (m)	$\leq 2000$

### Mechanical properties

Trip indication	Instantaneous tripping, rated residual current cannot be adjusted There is a mechanical indication window on the front to indicate residual current fault. When the residual current fault trips, the window changes from green to red.
Handle	red, pad printing indicates ON-OFF position
Mechanical life	20000 times
Electrical life	10000 times
Protection level: Installed in distribution box	IP40
Direct installation	IP20
Mechanical impact resistance	30g, 3 impacts, duration 11ms (Where there is no significant vibration or shock)
Heat and moisture resistance (IEC60068-2)	Category 2, 28 cycles, When the temperature is 55°C, the relative humidity is 90%~96% When the temperature is 25°C, the relative humidity is 95~100%
Base ambient temperature	30°C
Ambient operating temperature °C	-5°C~+40°C
Ambient storage temperature °C	-25°C~+55°C
Relative humidity	$\leq 95\%$

### Installation features

Maximum wiring capacity (A)	$I_n \leq 63A: \leq 16mm^2; I_n > 63A: \leq 35mm^2$
Maximum ultimate torque (N.m)	2
Tools	Phillips screwdriver or slotted screwdriver
Installation	Suitable for TH35-7.5 steel installation guide rail
Cable entry method:	Cable entry from above

Dimensions for Model CDL6i

• CDL6i-63

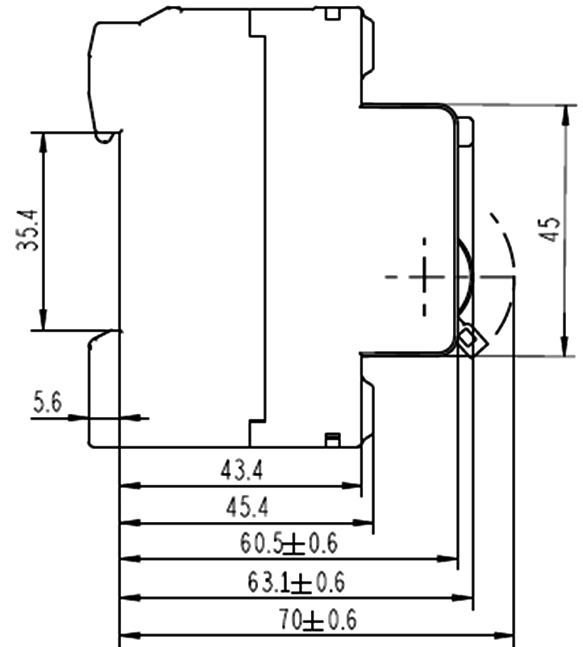
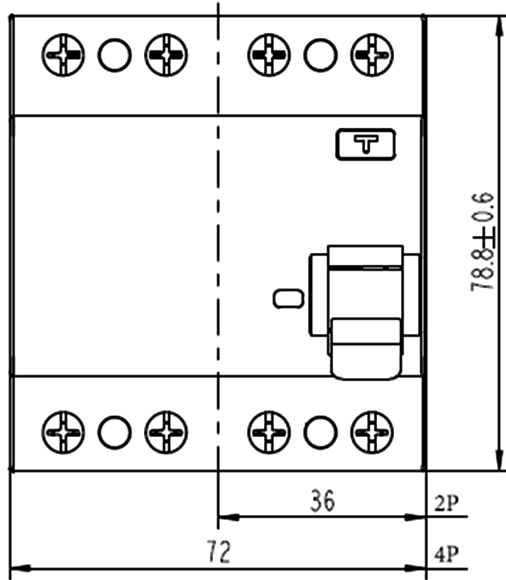

• CDL6i-100

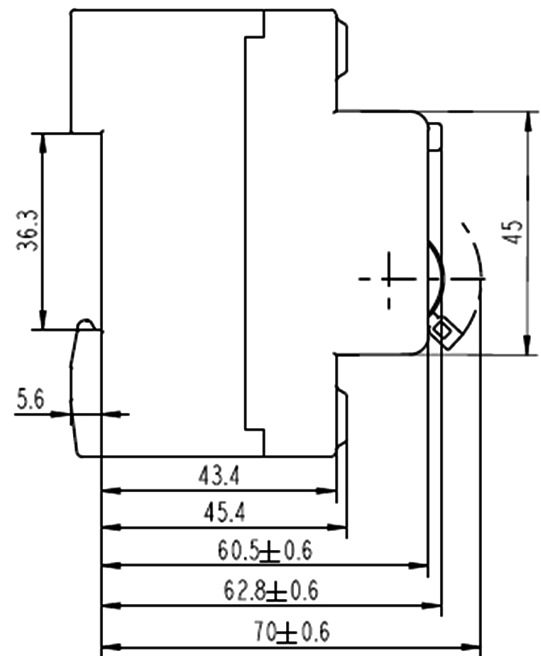
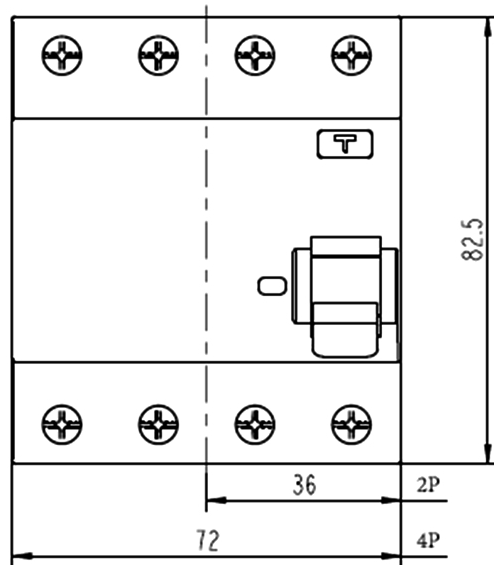

### Tripping Curve

The protection characteristics of overcurrent release are shown in the table

Overcurrent instantaneous Trip unit type	Rated current $I_n$ (A)	Test current (A)	Starting state	Test time	Expected result	Note	Benchmark temperature
B, C, D	$\leq 63$	$1.13I_n$	Cold state	$t \leq 1h$	No tripping	---	+30°C
B, C, D		$1.45I_n$	Immediately after the test	$t < 1h$	Trip	the current rises to the specified value within 5s	
B, C, D		$2.55I_n$	Cold state	$1s < t < 60s (I_n \leq 32A)$ $1s < t < 120s (I_n > 32A)$	Trip	---	
B, C, D		$3I_n / 5I_n / 14I_n$	Cold state	$t \leq 0.1s$	No tripping	Close the auxiliary switch to turn on the power	
B, C, D		$5I_n / 10I_n / 14I_n$	Cold state	$t \leq 0.1s$	Trip	Close the auxiliary switch to turn on the power	

The protection characteristic curves of the circuit breaker are shown in Figure 1

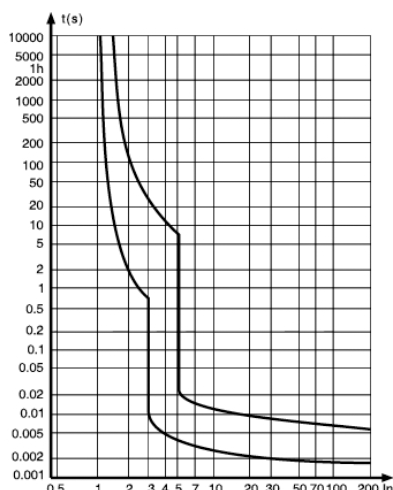

Figure 1: Type B thermal/electromagnetic tripping characteristic curve

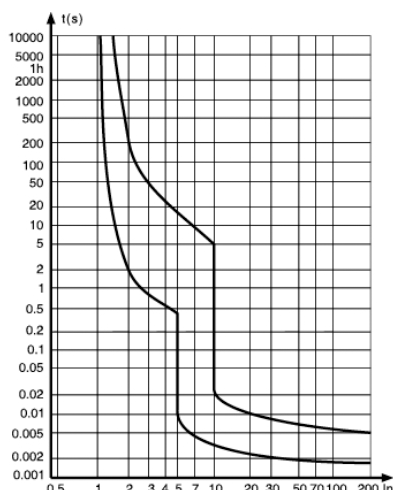

Figure 2: Type C thermal/electromagnetic tripping characteristic curve

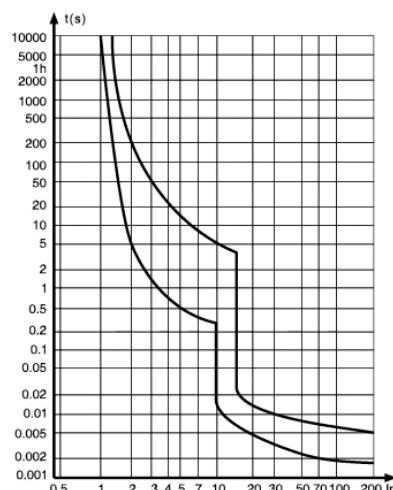

Figure 3: Type D thermal/electromagnetic tripping characteristic curve



**合格证**

德力西电气有限公司  
DELIXI ELECTRIC LTD

名称：剩余电流动作断路器

型号：CDL6i

本产品经检验合格准予出厂。

执行标准：GB16916.1

检验员：检02

出厂日期：见内盒标签

**德力西电气有限公司**  
**DELIXI ELECTRIC LTD**

浙江省乐清市柳市镇德力西高科技工业园区 邮编：325604

电话：(86-577)6177 8888

传真：(86-577)6177 8000

客服热线：400-826-8008

[www.delixi-electric.com](http://www.delixi-electric.com)

本使用说明书自2016年12月第一版