



ANLY TIMER

ATDV TWIN ANALOGUE TIMER



CHARACTERISTIC :

- Customized CMOS IC for low power consumption, high operation stability and extreme timing accuracy
- Independent adjustment for continuous ON-OFF operation and time
- 16 different time ranges available
- 2 operating voltage in a single unit, AC110V and 220V
- 5(A, B, C, D, E) timing series available*
- Each timing series has 4 time ranges, selectable via DIP switch*
- CE certified

Note: "*" indicates applicable to ATDV multi range series only

SPECIFICATION :

| | |
|-----------------------------------|--|
| Operating voltage | DC(V): 12, 24 AC(V): 12, 24, 110, 220, 240 |
| Allowable operating voltage range | 85~110% of rated operating voltage |
| Rated frequency | 50 / 60 Hz |
| Contact rating | 250VAC 5A (resistive load) |
| Reset time | MAX 0.2S |
| Power consumption | Approx. 2VA |
| Life | Mechanical: 5,000,000 times Electrical: 100,000 times |
| Ambient temperature | -10 ~ +50°C (without condensation & freezing) |
| Ambient humidity | MAX 85% RH (without condensation) |
| Altitude | MAX 2000m |
| Weight | Approx. 220g |

TYPE SELECTION :

| Model | Variable | Multi-Range Variable | | |
|-------------------|---|----------------------|---------------------|---------------------|
| Operating voltage | As specification shown | 110V / 220V | | |
| Output contact | 1C | 1C | | |
| Type | ATDV-N / Y | ATDV-NA / YA | ATDV-NB / YB | ATDV-NC / YC |
| Time range | 6S x 6S , 6S x 60S , 60S x 6S , 6M x 6M , 6M x 60M , 60M x 6M or 60M x 60M | 1S / 10S / 1M / 10M | 3S / 30S / 3M / 30M | 6S / 60S / 6M / 60M |
| Type | - - - - | ATDV-ND / YD | ATDV-NE / YE | |
| Time range | Upon clients' request, up to 12H | 1M / 10M / 1H / 10H | 3M / 30M / 3H / 30H | |

CONNECTION :

ATDV-N,Y

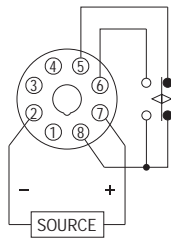

ATDV-□□

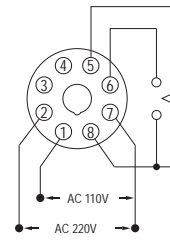

TIMING CHART :

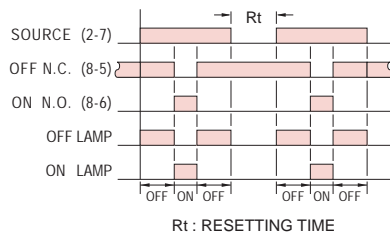

DIMENSIONS : (mm)

N type(Surface Mounting): Using 8PFA Socket

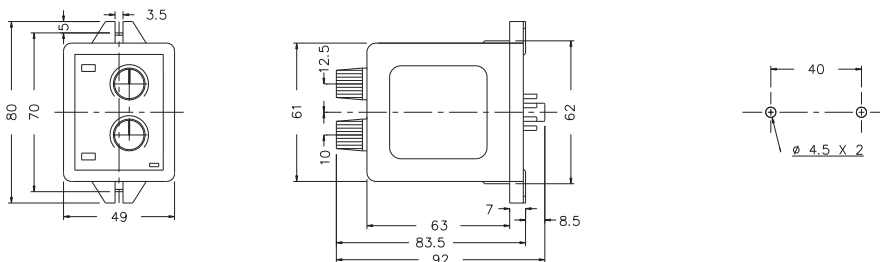

Y type(Flush Mounting): Using US-08 Socket or P3G-08 Socket

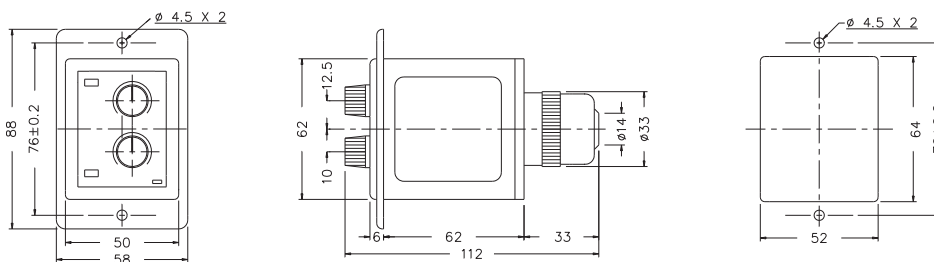

ANLY ELECTRONICS CO., LTD.

<http://www.anly.com.tw>

TAIWAN MAIN OFFICE : ANLY ELECTRONICS CO., LTD.

No.19, Lane 202, Fushou St., Xinzhuang Dist., New Taipei City 242, Taiwan
TEL: +886-2-2996-3202 FAX: +886-2-2996-2017

MALAYSIA BRANCH : JUSTY ELECTRONICS (M) SDN, BHD.

No.1, Jalan 6/89B, Kawasan Perindustrian Trisegi, Batu 3 1/2 Off Jalan Sungei Besi, 57100 Kuala Lumpur, Malaysia
TEL: +60-3-7983-5758 FAX: +60-3-7981-5052

HONG KONG BRANCH : ANLY ELECTRONICS (HK) LTD.

Flat K, 13/F, Edward Mansion, 141 Prince Edward Road W., Kowloon, Hong Kong
TEL: +852-2397-2505 FAX: +852-2397-6080

SHANGHAI BRANCH : ANLY TECHNOLOGY (WUXI) CO., LTD.

Room 13G, No.831, Xinzha Rd., Jingan District, Shanghai, China 200041
TEL: +86-21-6218-3300 FAX: +86-21-6217-5911

NO. ATDV-R-A