

PRPDUCTS

Solenoid Valves for Gas

HOME > PRPDUCTS > Solenoid Valves for Gas

SOLENOID VALVES >

SOLENOID VALVES FOR GAS >

SENSORS >

PNEUMATIC ACTUATOR VALVES >

ELECTRIC ACTUATOR VALVES >

EXPLOSION-PROOF PRODUCTS >

AGRICULTURAL IRRIGATION VALVE >

**EXPLOSION PROOF GAS SOLENOID VALVE
(Normally Closed, The Fast Opening and Fast Closing Type)**

HDG-EX 2015 / 2025 / 2040 / 2050

HDG-EX 2050F / 2065F / 2080F / 2100F



According to LVD 2006/95/EC

test required IEC 60730-1 (4th Edi.): 2010 / IEC 60730-2-6 (2th Edi.): 2008

Certification Criteria

: Protective equipment compulsory safety certification Notice

(Ministry of Employment and Labor Notice 2013-54)



Certification Number : 15-GA2BO-0771X / 0772X

Certification ratings : Ex d mb IIC T4 IP67

HDG-EX 2015 / 2025

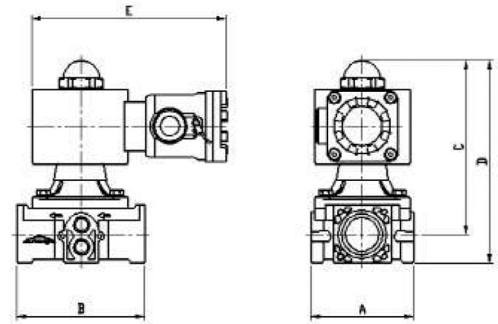

HDG-EX 2040 / 2050

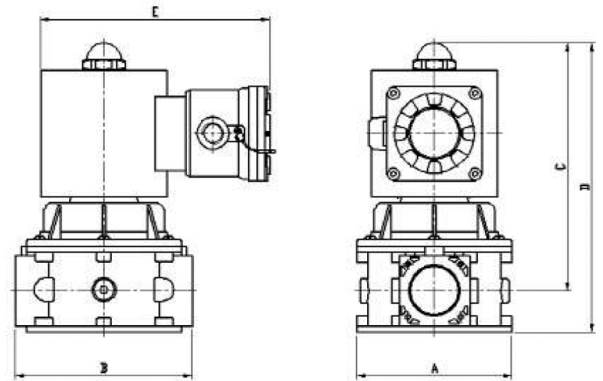

HDG-EX 2050F / 2065F / 2080F / 2100F

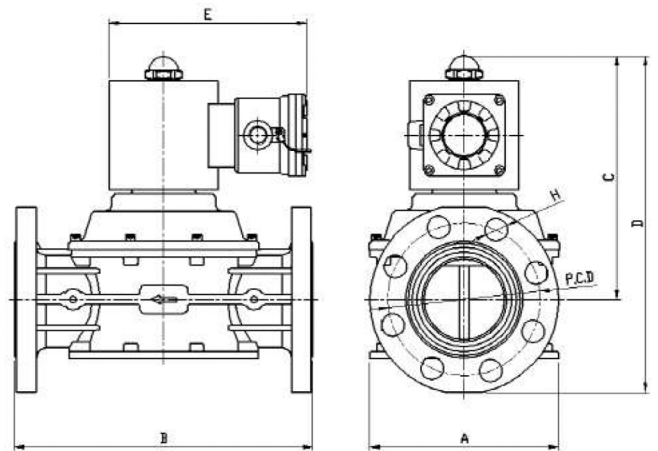

DIMENSION & TECHNICAL SPECIFICATION

- The Directly Fast Opening and Fast Closing Type -

MODEL	Overall (mm)						Weight (Kg)	Connection	Max. Operating Pressure (mbar)	Powwer Consumption
	A	B	C	D	E	H				
HDG-EX 2015 (15A)	88	110	150	175	168	-	3.0	Rp 1/2"	360	20VA
HDG-EX 2025 (25A)	88	110	150	175	168	-	3.0	Rp 1"	360	30VA
HDG-EX 2040 (40A)	140	160	221	262	207	-	8.0	Rp 1" 1/2	360	190VA / 53VA*
HDG-EX 2050 (50A)	140	160	221	267	207	-	8.0	Rp 2"	360	190VA / 53VA*
HDG-EX 2050F (50A)	145	227	221	297	207	4x18	8.0	DN 50	200	190VA / 53VA*
HDG-EX 2065F (65A)	187	270	223	313	207	4x18	14.5	DN 65	200	190VA / 53VA*
HDG-EX 2080F (80A)	198	313	225	353	207	8x18	14.5	DN 80	200	190VA / 53VA*
HDG-EX 2100F (100A)	198	316	282	390	207	8x18	16	DN 100	200	190VA / 53VA*

*Starting / Working

GENERAL SPECIFICATION

Working gas	LNG(Town gas), LPG, Air, Flue gas, Non-aggressive gas
Working voltage	AC 220V
Ambient temperature	-15 ~ 60 °C
Voltage tolerance	-15 ~ 10 %
Closing time	< 1 second
Opening time	< 1 second
Protection grade	IP 67 6- Dust tight, No ingress of dust 7- Protection against the effect of "temporary" immersion between 15cm~1m.

MATERIALS

Housing base	Aluminium diecast, Brass
Coil housing	Iron
Coil	enameled copper wires
Disk sheet	HNBR
Core	Pure Iron

CAPACITY DIAGRAM – HDG-EX series

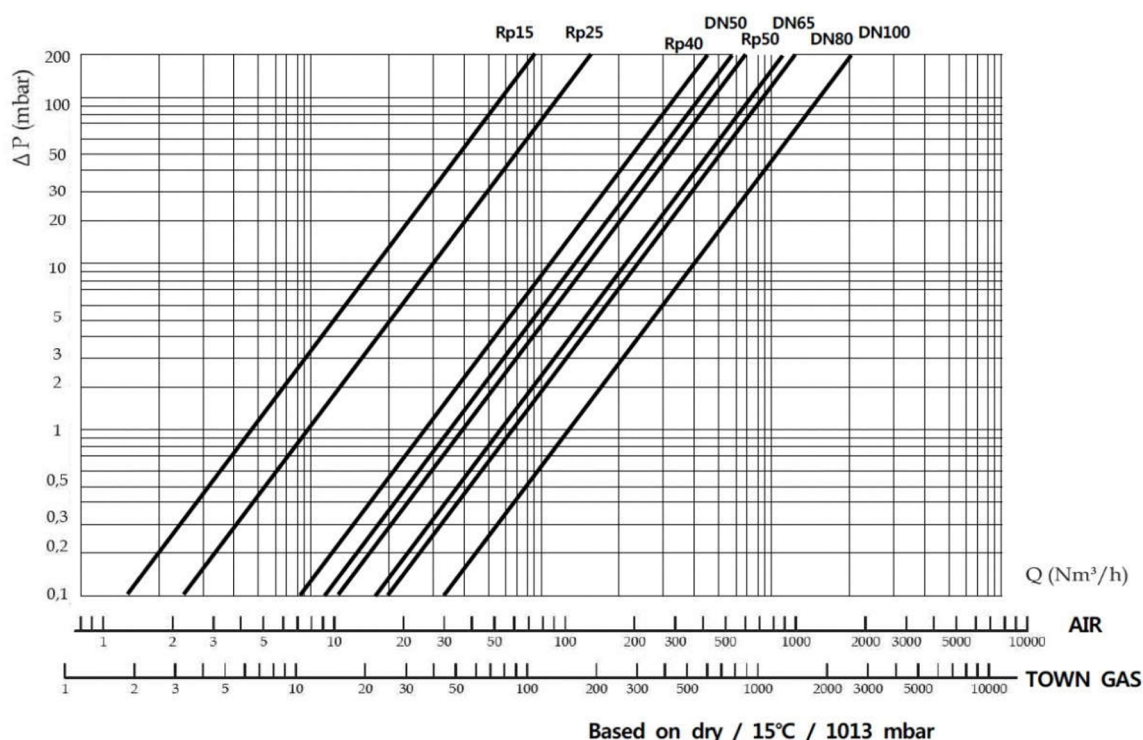

■ TECHNICAL DESCRIPTION

- HDG Series solenoid valves are fast opening single-stage valves directly act as the power held within one second, normally closed.
- If the power supply is shut off, the valve rapidly closes, interrupting the flow of gas. (within 1 second)
- This is suitable for air or gas blocking and releasing controls, required in gas power burners, atmospheric gas boilers, industrial kilns and other gas consuming appliances.

SAVING ENERGY

: HDG-EX 2040 / 2050 / 2050F / 2065F / 2080F / 2100F

- The starting power is being supplied to the solenoid coil and after 20 seconds it is down to 40% power to operate the solenoid coil, saving electricity.
- Keeping the temperature of the coil below 55 °C can prolong the lifetime of the product.
- If problems occur in the operation of the solenoid coil it must be immediately exchanged.

■ ATTENTION

All installation/maintenance work must be carried out by skilled staff. Always check that the system is gas-tight after installation.

Failure to follow this manual can result in dangerous situations or damage to the product.

■ INSTALLATION

1. Warning

- For proper and safe operation and long service life of the valve, consider the following recommendations of the valve during the design of the system when the valve is installed
 - Rated voltage and current
 - The degree of protection vessel
 - Dimensions of tolerance parallel thread
 - Attachment Method
 - The environment
 - Pull method
 - Location inlet section
 - Using leased lines
- Shut off the air/gas supply at the main manual shut-off valve and disconnect electrical power to the valve before proceeding with installation or servicing.
- Before installation, ake sure that the pipeline is free from impurities and vibration-free.
- Solenoid surface may be hot. Do not touch it with bare hands.
- The filter must be installed upstream of the solenoid valve for proper operation.
- Avoid excessive quantities of sealing agent which could enter in the valve.
- Use proper tools only and avoid overtightening.
- Make sure all gaskets are used properly.
- Please be sure protective measures to prevent easy access to the facilities.
- If you do not use the Rated voltage products can cause serious malfunction.
- After installation, function and leaking tests must be carried out.
- Perform maintenance must be done at least once a year.

2. Installation Location

- Valve may be mounted with coil in horizontal or vertical position, not upside down.
 - A gas filter should be always installed upstream the valve.
 - Ensure that installing area is protected from rain or moisture and sunlight.
 - It may cause the heat to the coil according to the installation environment.
- Don't install the valve in a position close to the wall or another device.

■ Standards and specifications of this product are subject to change without prior notice for improved performance.

ISO 9001 : 2008
ISO 14001 : 2004

INNOBIZ
기술혁신영웅기업

CE

CS